



**Richmond Hill**  
CITY CENTER

520 Cedar Street  
Richmond Hill, GA 31324  
(912) 445-0043  
www.richmondhillcitycenter.com







[goo.gl/maps/622rCnhzdF62](https://goo.gl/maps/622rCnhzdF62)



# Meetings



## QUICK FACTS:

- 2 Georgia Coast's most central conference center – centrally located between Savannah, Pooler, Statesboro & Brunswick.
- 2 12 Miles from Savannah & 17 Miles from Savannah/Hilton Head International Airport
- 2 Easily accessible from main highways (I-95 & I-16)
- 2 Over 20 branded hotels within a 2-6 mile radius
- 2 Secluded & private
- 2 Buy out options available for exclusive use & security
- 2 Full service venue
- 2 10,000 Square-feet of flexible indoor meeting space including 10 breakouts
- 2 For meetings & groups of all sizes up to 350 guests
- 2 6000 Square-feet of outdoor space
- 2 4000 Square-foot ballroom with floor to ceiling windows allowing for natural light if you choose or shades can be pulled down
- 2 State-of-the-art audio visual equipment & onsite technical support as needed
- 2 Fully equipped business center
- 2 Capability & inventory for all different meeting sets
- 2 Complimentary parking
- 2 All-inclusive meeting packages available. Catering & meal plan options
- 2 Award-winning culinary team
- 2 Seasoned banquet team
- 2 Dedicated Conference Planner & onsite Conference Manager.
- 2 Onsite Herb Garden
- 2 LEED Registered Meeting center
- 2 Follow IACC Standards

# CAPACITY/FLOOR PLAN



520 Cedar Street  
Richmond Hill, GA 31324

(912) 445-0043

[www.richmondhillcitycenter.com](http://www.richmondhillcitycenter.com)



[goo.gl/maps/622rCnhzdF62](https://goo.gl/maps/622rCnhzdF62)

## FIRST FLOOR

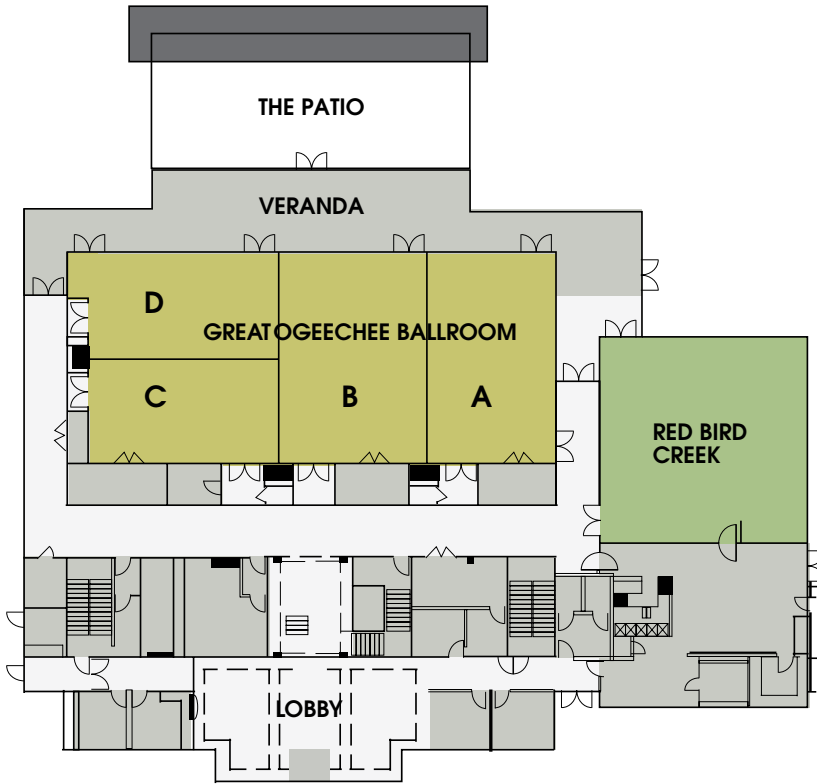

## SECOND FLOOR

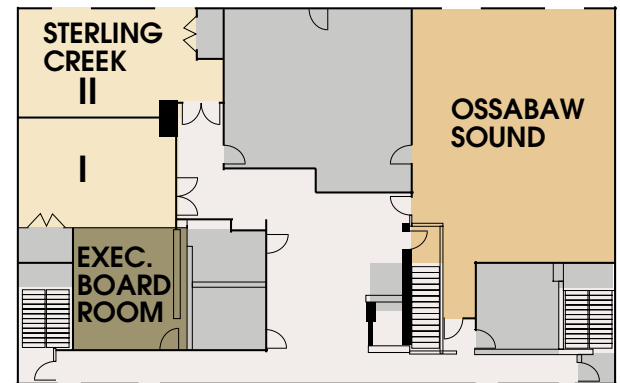

*Capacity per seating arrangement*

NAME OF SPACE	SQ. FT.	DIMEN.	THEATER	CLASSROOM	BANQUET ROUNDS	COCKTAILS
<b>GREAT OGEECHEE BALLROOM</b>	3977	96.3' X 41.3'	400	270	320	400
Gallery A	1061	25.7' X 41.3'	100	70	80	100
Gallery B	1193	28.9' X 41.3'	110	78	100	110
Gallery C	863	41.7' X 20.7'	80	50	60	80
Gallery D	863	41.7' X 20.7'	80	50	60	80
Gallery AB	2255	54.6' X 41.3'	220	150	200	220
Gallery CD	1722	41.7' X 41.3'	170	112	120	170
Gallery BCD	2916	70.6' X 41.3'	290	190	220	290
<b>RED BIRD CREEK</b>	1640	41.7' x 39.9'	N/A		N/A	160
<b>STERLING CREEK</b>	890	25.1' x 35.4'	80	50	60	80
Gallery I	445	25.1' x 17.7'	40	30	30	40
Gallery II	445	21.1' X 17.7'	40	30	30	40
<b>OSSABAW SOUND</b>	1244	32.8' x 41'	120	75	100	120
<b>EXECUTIVE BOARD ROOM</b>	350	18.1' x 19.2'	N/A	N/A	N/A	N/A
<b>THE VERANDA</b>	2004		N/A	N/A	60	200
<b>THE PATIO</b>	2700	60' x 45'	200	N/A	160	200